

# BOUGHTON HOUSE & GARDENS



[www.boughtonhouse.org.uk](http://www.boughtonhouse.org.uk)

## WELCOME TO BOUGHTON HOUSE

One of the great treasure houses of Europe. Set in a landscape inspired by Versailles, Boughton has been the home of the Montagu family and their descendants, the Dukes of Buccleuch and Queensberry for nearly five hundred years.

The ever evolving landscape has seen the recent addition of Orpheus **7** in 2009. Designed by Kim Wilkie, the inverted grass pyramid is the first new feature for nearly 300 years. Mirroring the great grass mount, it sinks nearly eight metres below the nearby canalised river Ise to a calm pool of reflection.



Inside the house Boughton hosts a special exhibition of the work of Marcellus Laroon, the 18th century painter, actor, soldier and man of pleasure who captured the spirit of the musical and social life of his time. Visitors to the exhibition can also see Boughton in vivid 3D, with screenings of the recent Sky production of *Treasure Houses of Britain*.

Entry is free with a House and Gardens ticket or £3 for those visiting the gardens.



Duke of Buccleuch with Selina Scott for *Treasure Houses of Britain*.

# BOUGHTON HOUSE & GARDENS

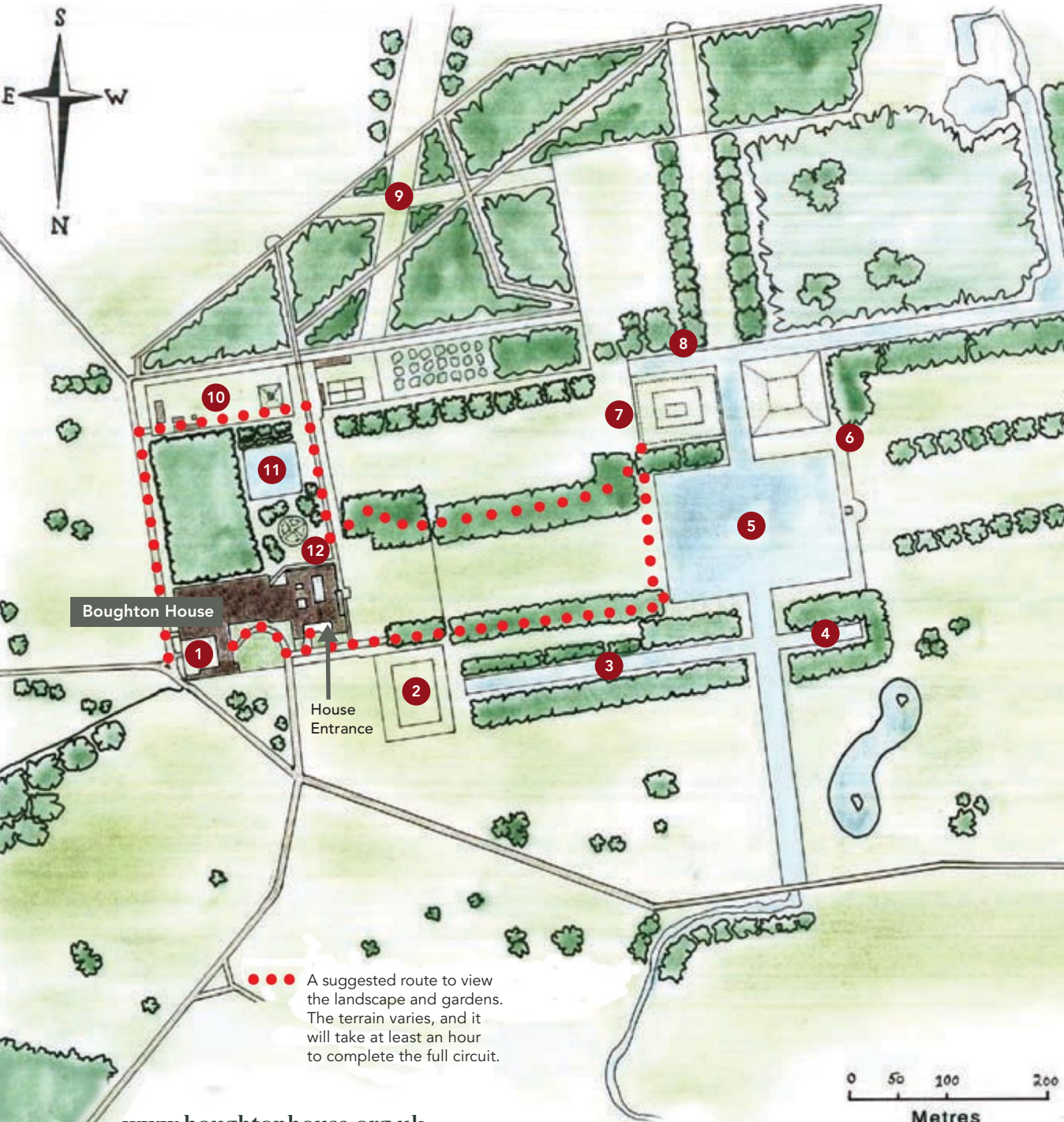

••• A suggested route to view the landscape and gardens. The terrain varies, and it will take at least an hour to complete the full circuit.

## 1 Stableyard

Visitor services including: Disabled Parking, Toilets, Gift Shop, Tearooms, Coach House, Trust Office.

## 2 Grand Etang

Created in the early 18th century as a reflecting pool for the House, it was also used for ice skating in the winter.

## 3 Dead Reach and 4 Little Reach

Inspired by the water features of Versailles, they formed part of the great canalisation scheme implemented on the orders of the 1st Duke of Montagu after Ambassadorial duties there.

## 5 Broadwater Lake

Evolving from the initial series of elaborate water basins the lake had reached its current size by 1746. Lost over the centuries to "benign neglect", it has now been restored and re-boarded to establish the original crispness.

## 6 The Mount

Created by the 2nd Duke of Montagu in 1723, the Mount was until recently masked in trees, now restored to its former glory, it provides a superb viewing point for those intrepid enough to make the journey to its heights.

## 7 Orpheus

The new project -'Orpheus' is intended to complement wonderfully the intelligent and visionary approach of the 1st and 2nd Dukes of Montagu.

## 8 Boat Reach

Recently restored the Reach forms part of the extensive canalised river system of the original water gardens.

## 9 The Wilderness

Created as formal avenues and woodland, key rides have been opened up to reveal the intended sight lines.

## 10 Walled Garden

With its restful sensory garden and colourful herbaceous border, the Walled Garden is a restful and inspiring place to spend a quiet afternoon.

## 11 The Lily Pond and 12 Rose Garden